



Jf[®] R-Concept

Jf[®] R-Concept



unlimited possibilities, exclusive designs, maximum functionality; this is what our r-concept is all about



Tubo Inox BA AISI-316

LG	ØA	E*
3000-6000	12	1
3000-6000	20	1,5
3000-6000	43	1,5
3000-6000	50,8	1,5

BA SATIN

+design

BA

Acabado brillo / Polished finished / Finition poli

SATIN

Acabado satinado / Satin finished / Finition brossé



AV 650 BA AISI-316

pcs/box	ØA	A	B
New! > 4	20	11,5	55
New! > 2	38,1	22,5	99
2	43	22,5	99
2	50,8	22,5	99
New! > 2	63,5	24	110

BA SATIN

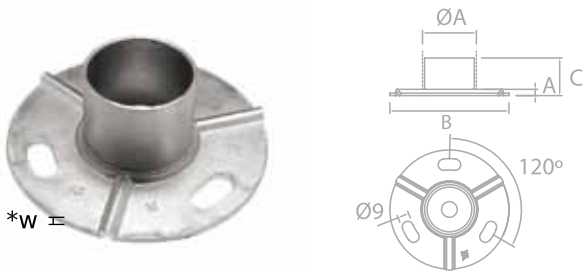

BS 00 BA AISI-316

pcs/box	ØA	A	B	C	E*
New! > 2	38,1	5	95	35	1,5
2	43	5	95	35	1,5
2	50,8	5	95	35	1,5



*w (espesor / wall thickness / épaisseur: 4mm)

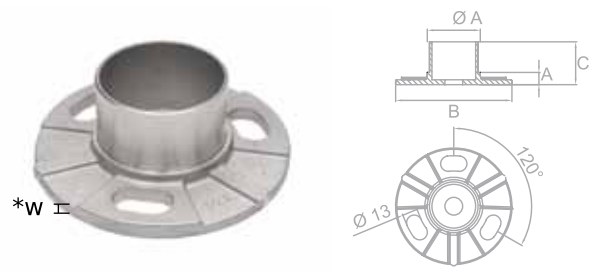

BS 01 BA AISI-316

New! >

pcs/box	ØA	A	B	C	E*
2	38,1	10	95	35	1,5
2	40	10	95	35	1,5
2	43	10	95	35	1,5
2	50,8	10	95	35	1,5



*w (espesor / wall thickness / épaisseur: 8mm)



AV 603 BA AISI-316

pcs/box	ØA	A	B	E*
New! > 2	38,1	22,5	99	1,5
2	43	22,5	99	1,5
2	50,8	22,5	99	1,5



*w (espesor / wall thickness / épaisseur: 4mm)

BA SATIN



AV 604 BA AISI-316

New! >

pcs/box	ØA	A	B	E*
2	38,1	22,5	99	1,5
2	40	22,5	99	1,5
2	43	22,5	99	1,5
2	50,8	22,5	99	1,5



*w (espesor / wall thickness / épaisseur: 8mm)

BA SATIN



BA SATIN



CREAMOS TENDENCIA RENOVANDO CONCEPTOS
WE CREATE TRENDS BY RENEWING CONCEPTS
NOUS CRÉONS DES TENDANCES, EN RÉNOVANT LES CONCEPTS

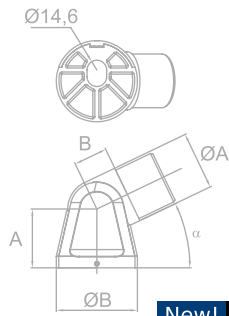

SA 451 BA AISI-316

New!

pcs/box	ØA	ØB	A	B	α
2	38,1	60	43,5	25	26-90
2	43	60	43,5	25	26-90
2	50,8	60	43,5	25	26-90



BA SATIN



Instalación / Installation / Installation

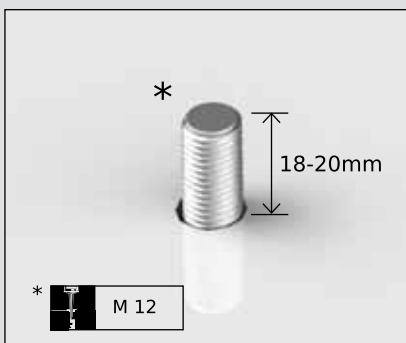

[img.1]



[img.2]

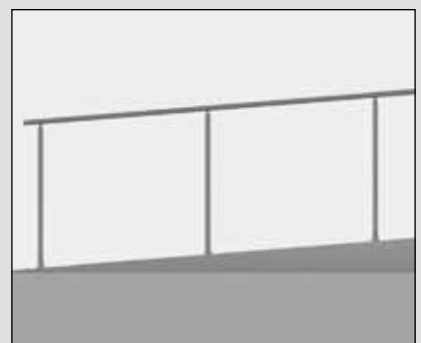

[img.3]



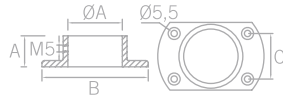

AV 600 BA AISI-316

pcs/box	ØA	A	B	C
2	38,1	34	75	28
2	43	35	85	34
2	50,8	36	96	39



BA SATIN

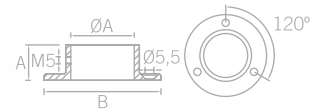

AV 601 BA AISI-316

pcs/box	ØA	A	B
2	38,1	24	75
2	43	25	80
2	50,8	31	102



BA SATIN

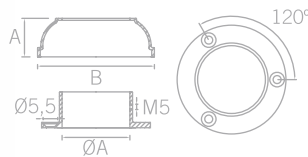

AV 602 BA AISI-316

pcs/box	ØA	A	B
2	38,1	25	73
2	43	26	82
2	50,8	29	85



BA SATIN

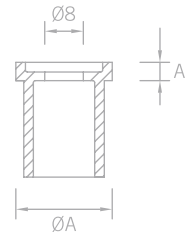

ST 308 BA AISI-316

pcs/box	ØA	A	E*
4	20	4	1,5
New! >	2	38,1	4
New! >	2	43	4
New! >	2	50,8	4

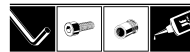

BA SATIN

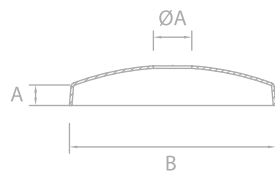

AV 651 BA AISI-316

pcs/box	ØA	A	B
4	12	6	66

BA SATIN

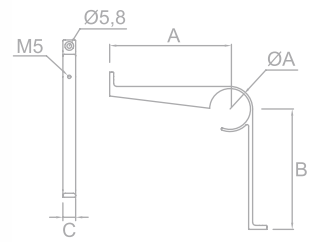

ST 336 BA AISI-316

New! ▾

pcs/box	ØA	A	B	C
2	50,8	150	150	16



BA SATIN

JF RESTYLING

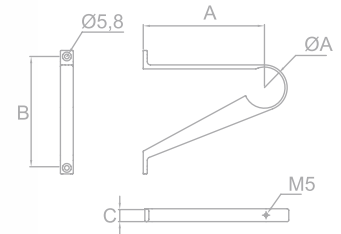

ST 337 BA AISI-316

New! ▾

pcs/box	ØA	A	B	C
2	50,8	150	140	16



BA SATIN

NOSOTROS DISEÑAMOS, TÚ ELIGES
YOU CHOOSE, WE DESIGN
NOUS DESSINONS, TU CHOISIS

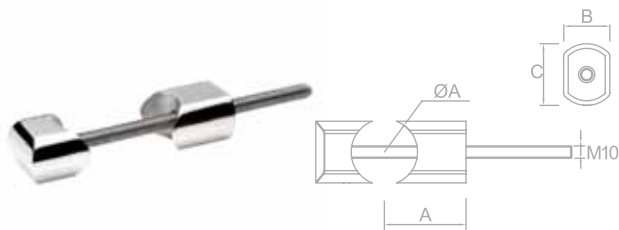

SL 1120 BA AISI-316

New! ▾

kit/box	ØA	A	B	C
1 kit*	38,1	51	25	30
1 kit*	43	53	30	40
1 kit*	50,8	57	30	40



1 KIT*: 2 pcs

BA SATIN

Instalación / Installation / Installation ▾



BA Acabado brillo / Polished finished / Finition poli

SATIN Acabado satinado / Satin finished / Finition brossé



Consultar JF BRICO / View JF Brico / Consulter JF BRICO

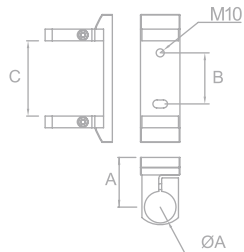

SL 1101 BA AISI-316

New! ▾

pcs/box	ØA	A	B	C
1	38,1	68	70	100
1	43	68	70	100
1	50,8	103	60	100

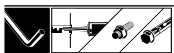

BA SATIN

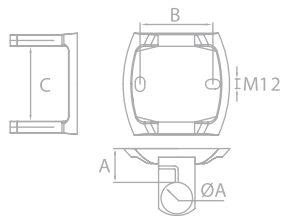

SL 1100 BA AISI-316

pcs/box	ØA	B	C
New! ▸ 1	38,1	100	120
1	43	100	120
New! ▸ 1	50,8	100	120

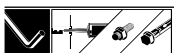

BA SATIN

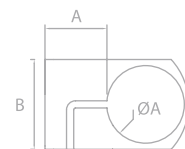

SL 1180 BA AISI-316

pcs/box	ØA	A	B
2	43	34,5	50



BA SATIN

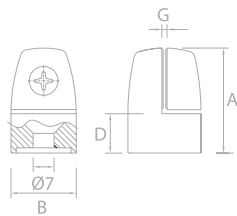

CC 770 BA AISI-316

pcs/box	A	B	D	G
4	40	25	15	(1-4)

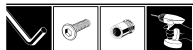

BA SATIN

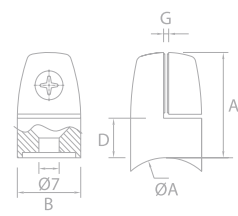

CC 771 BA AISI-316

pcs/box	ØA	A	B	D	G
4	50,8	40	25	15	(1-4)

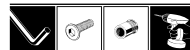

BA SATIN

BA Acabado brillo / Polished finished / Finition poli

SATIN Acabado satinado / Satin finished / Finition brossé



Consultar JF BRICO / View JF Brico / Consulter JF BRICO

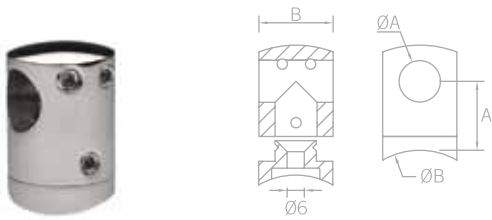

ST 320 BA AISI-316

pcs/box	ØA	ØB	A	B
4	12	43	20	21
4	12	50,8	20	21
4	14	43	21	23
4	14	50,8	21	23
4	16	43	25	26
4	16	50,8	25	26
4	20	43	25	30
4	20	50,8	25	30

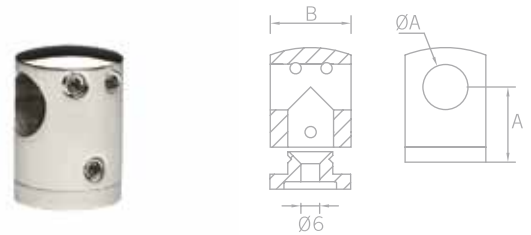
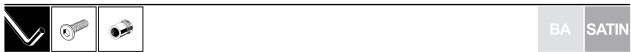

ST 321 BA AISI-316

pcs/box	ØA	A	B
4	12	20	21
4	14	21	23
4	16	25	26
4	20	25	30

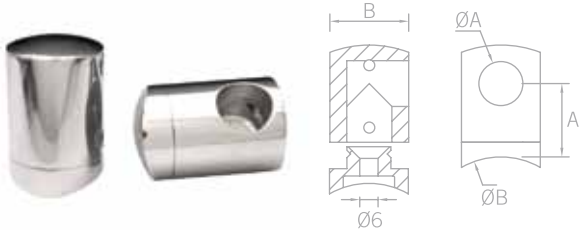

ST 322 BA AISI-316

pcs/box	ØA	ØB	A	B	L/R
4	12	43	20	21	L/R
4	12	50,8	20	21	L/R
4	16	43	25	23	L/R
4	16	50,8	25	23	L/R
4	20	43	25	30	L/R
4	20	50,8	25	30	L/R

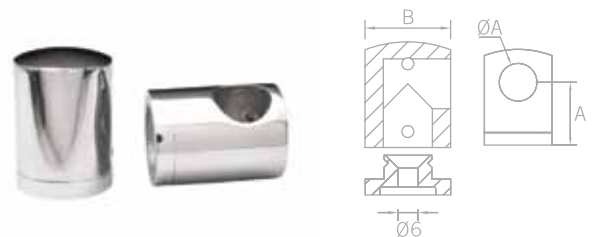

ST 323 BA AISI-316

pcs/box	ØA	A	B	L/R
4	12	20	21	L/R
4	16	25	26	L/R
4	20	25	30	L/R

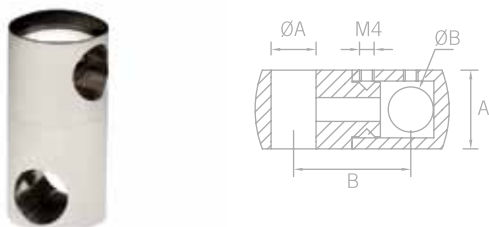
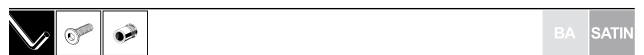

ST 324 BA AISI-316

pcs/box	ØA	ØB	A	B
4	12	12	21	25

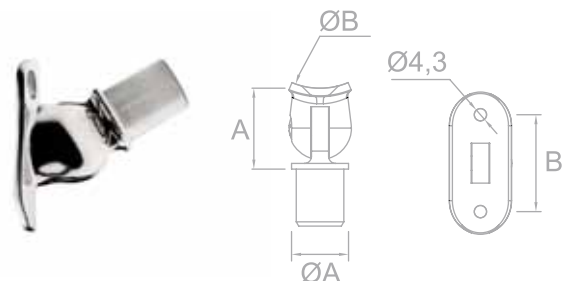
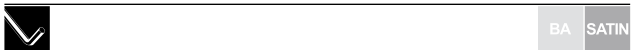

SA 400 BA AISI-316

pcs/box	ØA	ØB	A	B	E*
4	20	43	28	48	1,5
4	20	50,8	28	48	1,5

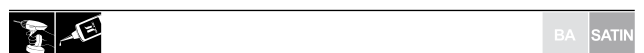



SA 405 BA AISI-316

New design! ▾

pcs/box	ØA	A
4	12	31
4	20	42



BA SATIN

Instalación / Installation / Installation ▾



[img.1]



[img.2]

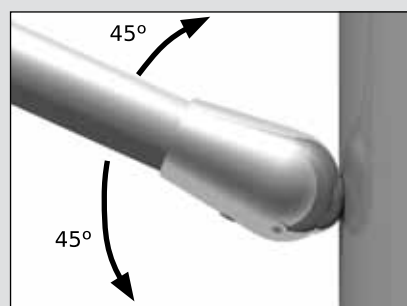

[img.3]

BA Acabado brillo / Polished finished / Finition poli

SATIN Acabado satinado / Satin finished / Finition brossé



Consultar JF BRICO / View JF Brico / Consulter JF BRICO

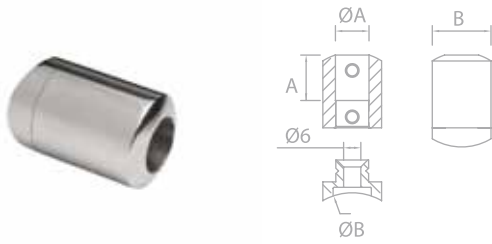

ST 325 BA AISI-316

pcs/box	ØA	ØB	A	B
4	12	43	16	21
4	12	50,8	16	21



BA SATIN

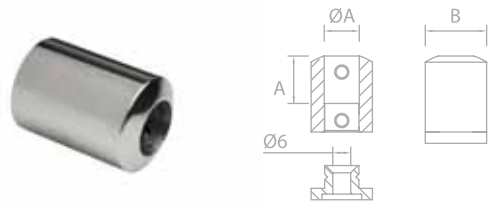

ST 326 BA AISI-316

New! ▾

pcs/box	ØA	A	B
4	12	16	21



BA SATIN



BA SATIN

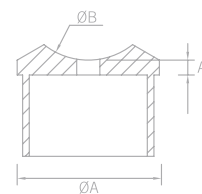
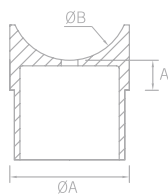

ST 309 BA AISI-316

New dimensions! 

pcs/box	ØA	ØB	A	E*
4	20	43	4	1,5
4	20	50,8	4	1,5
New! 	38,1	38,1	17	1,5
2	38,1	50,8	9	1,5
2	43	43	12	1,5
2	50,8	50,8	9	1,5



BA SATIN

ST 310 BA AISI-316

pcs/box	ØA	ØB	A	E*
4	20	43	4	1,5
4	20	50,8	4	1,5
2	38,1	38,1	5	1,5
2	38,1	50,8	5	1,5
2	43	43	5	1,5
2	50,8	50,8	5	1,5



BA SATIN

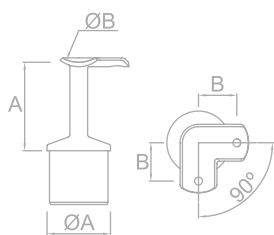

ST 319 BA AISI-316

New! ▾

pcs/box	øA	øB	A	B	E*
2	38,1	38,1	55	24	1,5
2	38,1	50,8	55	24	1,5
2	43	43	60	24	1,5
2	50,8	50,8	65	30	1,5



BA SATIN

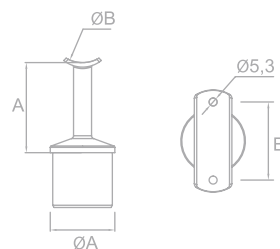

ST 302 BA AISI-316

New design! ▾

pcs/box	øA	øB	A	B	E*
2	38,1	38,1	55	48	1,5
2	38,1	50,8	55	48	1,5
2	43	43	60	52	1,5
2	50,8	50,8	65	60	1,5



BA SATIN

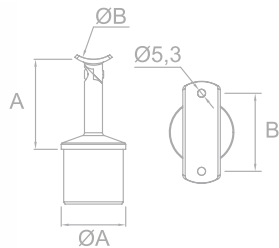

SA 404 BA AISI-316

New design! ▾

pcs/box	øA	øB	A	B	E*
2	38,1	38,1	55	48	1,5
2	38,1	50,8	55	48	1,5
2	43	43	60	52	1,5
2	50,8	50,8	65	60	1,5



BA SATIN

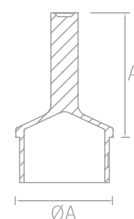

ST 330 BA AISI-316

pcs/box	øA	A	E*
2	38,1	55	1,5
2	43	55	1,5
2	50,8	55	1,5



BA SATIN



BA
SATIN

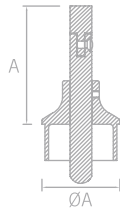

SA 420 (BG 00) BA AISI-316

pcs/box	ØA	A	E*
2	43	30-100	1,5
2	50,8	30-100	1,5



BA SATIN

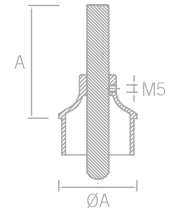

SA 420 (BF 00) BA AISI-316

pcs/box	ØA	A	E*
2	43	30-100	1,5
2	50,8	30-100	1,5



BA SATIN

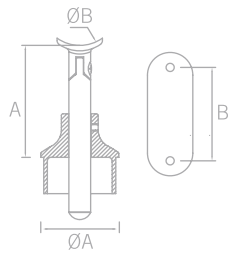

SA 420 (BG R) BA AISI-316

pcs/box	ØA	ØB	A	B	E*
2	43	43	30-100	51,5	1,5
2	43	50,8	30-100	61,5	1,5
2	50,8	43	30-100	51,5	1,5
2	50,8	50,8	30-100	61,5	1,5



BA SATIN

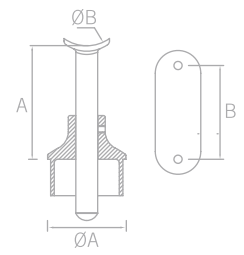

SA 420 (BF R) BA AISI-316

pcs/box	ØA	ØB	A	B	E*
2	43	43	30-100	51,5	1,5
2	43	50,8	30-100	61,5	1,5
2	50,8	43	30-100	51,5	1,5
2	50,8	50,8	30-100	61,5	1,5



BA SATIN

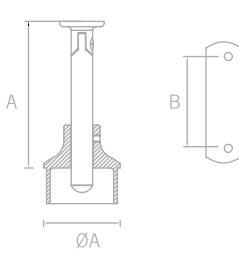

SA 420 (BG FLAT) BA AISI-316

pcs/box	ØA	A	B	E*
2	43	30-100	51,5	1,5
2	50,8	30-100	51,5	1,5



BA SATIN

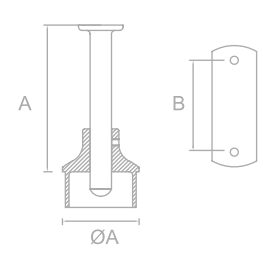

SA 420 (BF FLAT) BA AISI-316

pcs/box	ØA	A	B	E*
2	43	30-100	51,5	1,5
2	50,8	30-100	51,5	1,5



BA SATIN

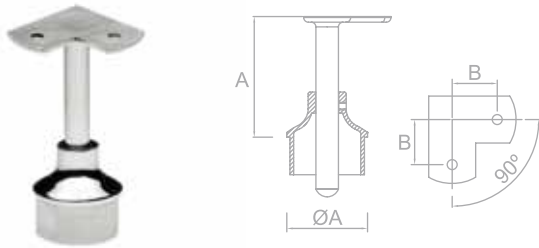

SA 420 (BFC FLAT 90) BA AISI-316 New! ▼

pcs/box	øA	A	B	E*
2	43	30-100	24	1,5
2	43	30-100	24	1,5
2	50,8	30-100	24	1,5
2	50,8	30-100	24	1,5

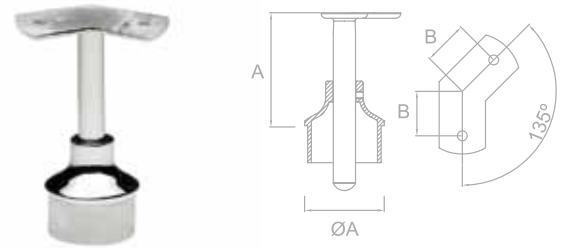

SA 420 (BFC FLAT 135) BA AISI-316 New! ▼

pcs/box	øA	A	B	E*
2	43	30-100	24	1,5
2	43	30-100	24	1,5
2	50,8	30-100	24	1,5
2	50,8	30-100	24	1,5

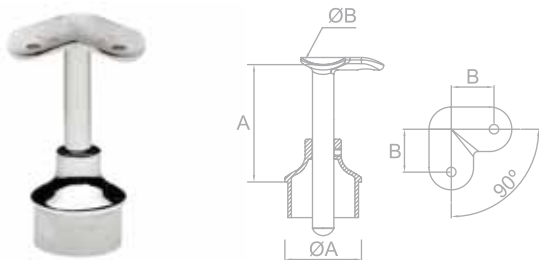

SA 420 (BFC R 90) BA AISI-316 New! ▼

pcs/box	øA	øB	A	B	E*
2	43	43	30-100	24	1,5
2	43	50,8	30-100	24	1,5
2	50,8	43	30-100	24	1,5
2	50,8	50,8	30-100	24	1,5

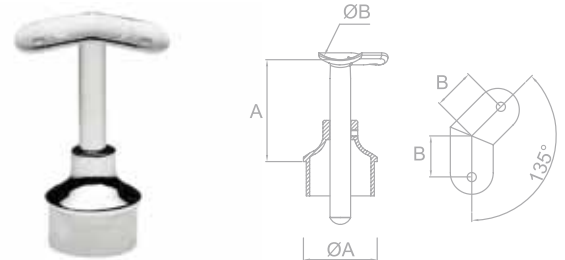

SA 420 (BFC R 135) BA AISI-316 New! ▼

pcs/box	øA	øB	A	B	E*
2	43	43	30-100	24	1,5
2	43	50,8	30-100	24	1,5
2	50,8	43	30-100	24	1,5
2	50,8	50,8	30-100	24	1,5



Instalación / Installation / Installation ▼



[img.1]



[img.2]





+ design

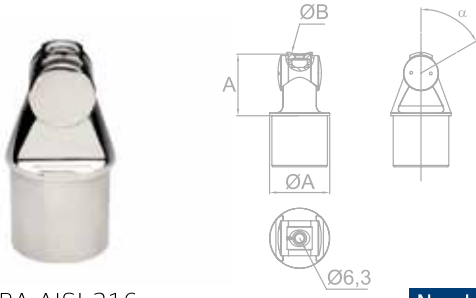

SA 450 BA AISI-316

New!

pcs/box	ØA	ØB	A	α
2	38,1	38,1	44	60°
2	38,1	50,8	44	60°
2	43	43	44	60°
2	50,8	38,1	44	60°
2	50,8	50,8	44	60°



BA SATIN



Instalación / Installation / Installation



[img.1]



[img.2]



[img.3]

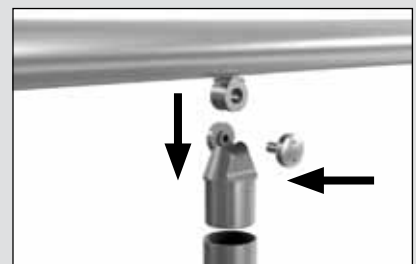

[img.4]



BA
SATIN

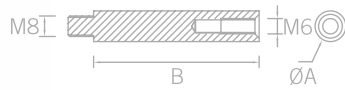

ST 380 BA AISI-316

pcs/box	ØA	B
2	12	65



BA SATIN

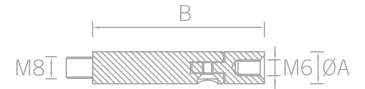

SA 480 BA AISI-316

pcs/box	ØA	B
2	12	65



BA SATIN

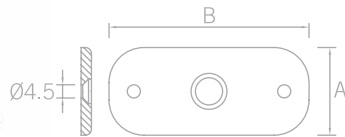

ST 390 BA AISI-316

pcs/box	A	B
4	30	68,5



BA SATIN

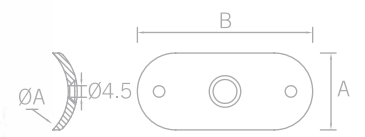

ST 391 BA AISI-316

pcs/box	ØA	A	B
4	43	30	68,5
4	50,8	30	78,5



BA SATIN

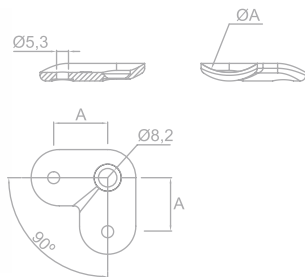

ST 392 BA AISI-316

New!

pcs/box	ØA	A
4	38,1	24
4	43	24
4	50,8	24



BA SATIN

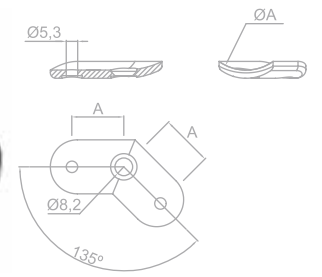

ST 394 BA AISI-316

New!

pcs/box	ØA	A
4	38,1	24
4	43	24
4	50,8	24



BA SATIN



special!

**ACCESORIOS PARA SOLDAR
WELDING FITTINGS
ACCESSOIRES POUR SOUDER**



BS 00



BS-01



BS-10



SA 421 (BF-00)



SA 421 (BG-00)



ST 330



ST 350



ST 351



ST 380



SA 420 (BF-00)



SA 420 (BG-00)



SA 480



SA 423(BF-00)



SA 423(BG-00)



SA 440(BF-00)



SA 440(BG-00)



ST 381



SA 481



ST-331

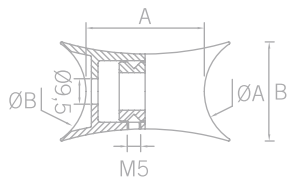

ST 312 BA AISI-316

pcs/box	ØA	ØB	A	B
2	43	43	44	37
2	50,8	50,8	44	37



BA SATIN

Instalación / Installation / Installation 

[img.1]



[img.2]

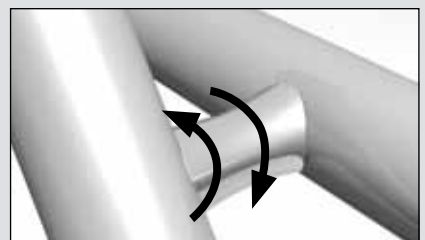

[img.3]



Acabado brillo / Polished finished / Finition poli



Acabado satinado / Satin finished / Finition brossé



Consultar JF BRICO / View JF Brico / Consulter JF BRICO

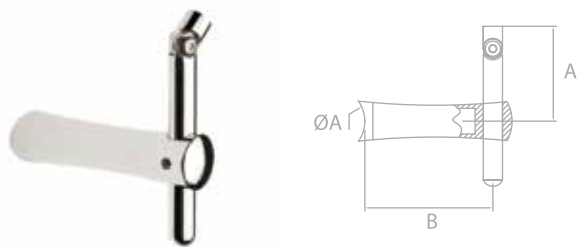

SA 421 (BG 00) BA AISI-316

pcs/box	øA	A	B
2	43	30-70	80
2	50,8	30-70	80



BA SATIN

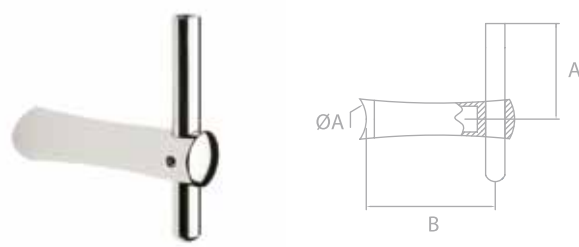

SA 421 (BF 00) BA AISI-316

pcs/box	øA	A	B
2	43	30-70	80
2	50,8	30-70	80



BA SATIN

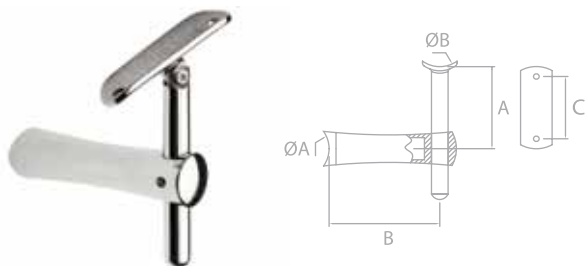

SA 421 (BG R) BA AISI-316

pcs/box	øA	øB	A	B	C
2	43	43	30-70	80	51,5
2	43	50,8	30-70	80	61,5
2	50,8	43	30-70	80	51,5
2	50,8	50,8	30-70	80	61,5



BA SATIN

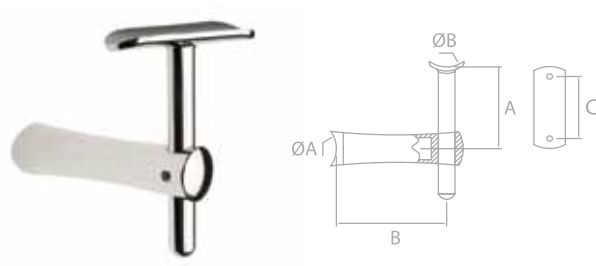

SA 421 (BF R) BA AISI-316

pcs/box	øA	øB	A	B	C
2	43	43	30-70	80	51,5
2	43	50,8	30-70	80	61,5
2	50,8	43	30-70	80	51,5
2	50,8	50,8	30-70	80	61,5



BA SATIN

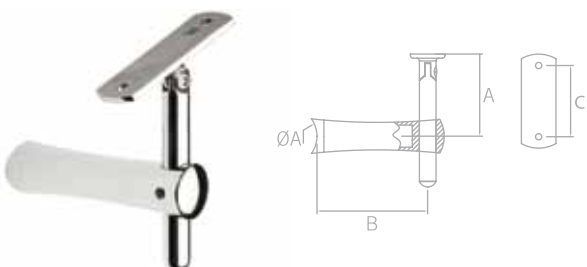

SA 421 (BG FLAT) BA AISI-316

pcs/box	øA	A	B	C
2	43	30-70	80	51,5
2	50,8	30-70	80	51,5



BA SATIN

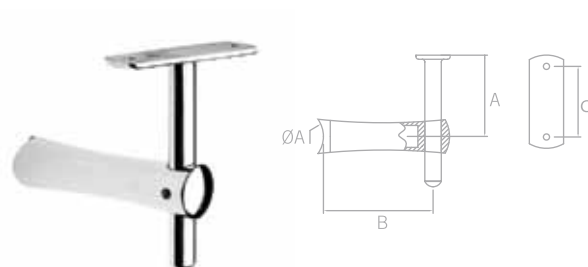

SA 421 (BF FLAT) BA AISI-316

pcs/box	øA	A	B	C
2	43	30-70	80	51,5
2	50,8	30-70	80	51,5



BA SATIN

New! ▾

FLEXIBLE Y FUNCIONAL

FLEXIBLE AND FUNCTIONAL

FLEXIBLE ET FONCTIONNEL

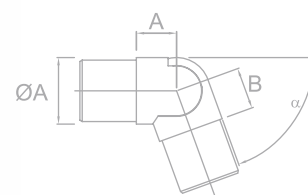

SA 406 BA AISI-316

New! ▾

pcs/box	ØA	A	B	E*	α
4	12	8	8	1	0-90
4	20	13	13	1,5	0-70
2	38,1	23	23	1,5	0-70
2	43	26	26	1,5	0-70
2	50,8	32	32	1,5	0-70



BA SATIN

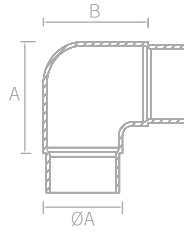

CT 200 BA AISI-316

pcs/box	ØA	A	B	E*
New! > 2	38,1	55	55	1,5
2	43	55	55	1,5
2	50,8	60	60	1,5



BA SATIN

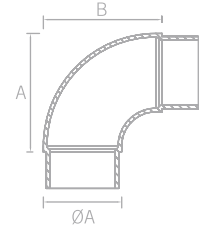

CT 201 BA AISI-316

New dimensions! ▾

pcs/box	ØA	A	B	E*
New! > 4	20	30	30	1,5
2	43	55	55	1,5
2	50,8	60	60	1,5



BA SATIN

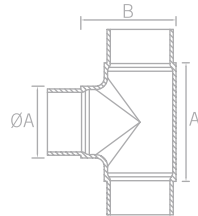

CT 202 BA AISI-316

pcs/box	ØA	A	B	E*
2	43	71	57	1,5
2	50,8	69	60	1,5



BA SATIN

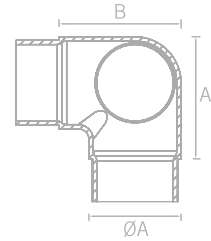

CT 205 BA AISI-316

pcs/box	ØA	A	B	E*
2	43	55	55	1,5
2	50,8	60	60	1,5



BA SATIN

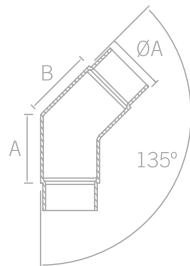

CT 206 BA AISI-316

pcs/box	ØA	A	B	E*
2	43	50	50	1,5
2	50,8	50	50	1,5



BA SATIN

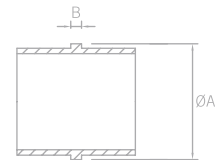

CT 207 BA AISI-316

New dimensions! ▾

pcs/box	ØA	B	E*
New! > 4	12	2	1
New! > 4	20	4	1,5
2	38,1	4	1,5
2	43	4	1,5
2	50,8	4	1,5



BA SATIN



BA
SATIN

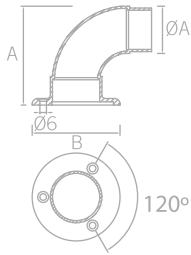

CT 208 BA AISI-316

pcs/box	ØA	A	B	E*
2	38,1	83	75	1,5
2	43	90	80	1,5
2	50,8	95	102	1,5



BA SATIN



CT 209 BA AISI-316

pcs/box	ØA	A	B
4	12	30	16,5



BA SATIN

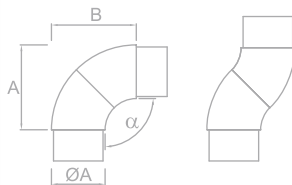

SA 402 BA AISI-316

pcs/box	ØA	A	B	E*	α
2	43	65	65	1,5	90-180
2	50,8	78	78	1,5	90-180



BA SATIN

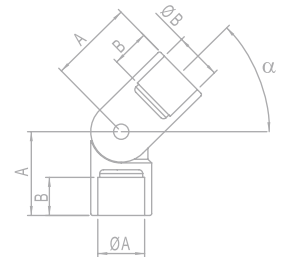

SA 486 BA AISI-316

pcs/box	ØA	ØB	A	B	α
2	12	12	22	10	0-90



New! ▾

BA SATIN



BA Acabado brillo / Polished finished / Finition poli

SATIN Acabado satinado / Satin finished / Finition brossé



Consultar JF BRICO / View JF Brico / Consulter JF BRICO



TF 502 BA AISI-316

pcs/box	ØA	A	E*
4	12	2	1
4	14	2	1,5
4	15	2	1,5
4	16	2	1,5
4	18	2	1,5
4	20	2	1,5
4	25	2	1,5
2	30	2	1,5
2	33	2	1,5
2	38,1	2	1,5
2	40	2	1,5
2	43	2	1,5
2	50,8	2	1,5
2	63,5	2	1,5



BA SATIN

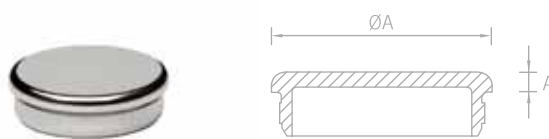

TF 507 BA AISI-316

pcs/box	ØA	A	E*
2	43	4	1,5
2	50,8	4	1,5



BA SATIN

Instalación / Installation / Installation

Instalación TF-507

Se coloca la pieza en el margen final del tubo y con un golpe seco de un martillo de nylon o goma se introduce en el interior del tubo. [img.2]

La tapa queda perfectamente fijada al tubo. [img.3]



[img.1]

TF-507 Installation

Place the piece in the far end of the tube and use a nylon or rubber hammer to introduce it inside the tube. [img.2]

The end cap will be perfectly fixed to the tube. [img.3]



[img.2]

TF-507 Installation

La pièce est posée sur le rebord final du tube. En donnant un coup de marteau en nylon ou en plastique, elle s'enfonce dans le tube. [img.2]

L'embout restera ainsi parfaitement fixé au tube. [img.3]



[img.3]



BA SATIN

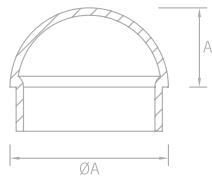

TF 501 BA AISI-316

pcs/box	$\varnothing A$	A	E*
2	38,1	19,5	1,5
2	43	21,5	1,5
2	50,8	25	1,5



BA SATIN

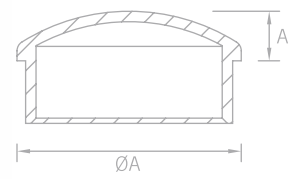

TF 505 BA AISI-316

pcs/box	$\varnothing A$	A	E*
2	38,1	8	1,5
2	43	9,5	1,5
2	50,8	12	1,5



BA SATIN

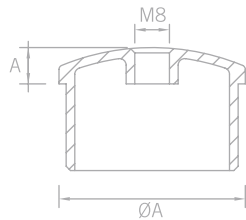

TF 503 BA AISI-316

pcs/box	$\varnothing A$	A	E*
2	43	8,4	1,5
2	50,8	8,4	1,5



BA SATIN

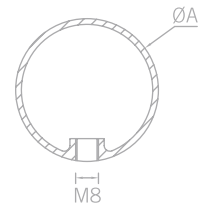

TF 504 BA AISI-316

pcs/box	$\varnothing A$
2	50
2	70

BA SATIN

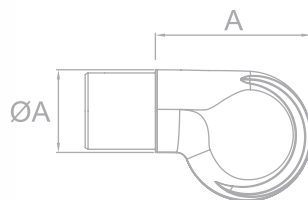

TF 511 BA AISI-316

New!

pcs/box	$\varnothing A$	A
2	43	81



BA SATIN

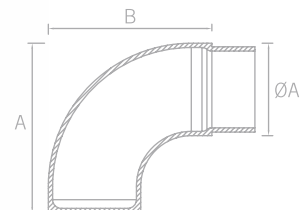

TF 506 BA AISI-316

pcs/box	$\varnothing A$	A	B	E*
2	50,8	83	80	1,5



BA SATIN



Acabado brillo / Polished finished / Finition poli



Acabado satinado / Satin finished / Finition brossé



Consultar JF BRICO / View JF Brico / Consulter JF BRICO

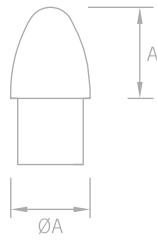

TF 508 BA AISI-316

pcs/box	ØA	A	E*
4	12	14	1



BA SATIN

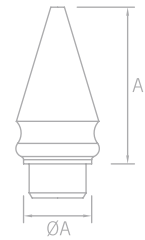

TF 509 BA AISI-316

pcs/box	ØA	A	E*
4	20	46	1,5



BA SATIN

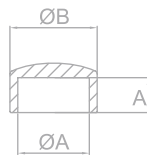

TF 510 BA AISI-316 *

New! ▼

pcs/box	ØA	A	ØB
4	12	6	15



BA SATIN

- * Tapa para varilla
- * End cap for rods
- * Bouchon pour tige

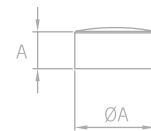

TF 590 BA AISI-316 *

New! ▼

pcs/box	ØA	A	M
4	18	11	MT M8 / CH M6
4	21,5	12	MT M10 / CH M8



BA SATIN

- * Tapa para anclaje metálico
- * End cap for metal anchor
- * Bouchon pour cheville métallique

Instalación / Installation / Installation ▼



TF 510

Instalación / Installation / Installation ▼



TF 590



BA SATIN

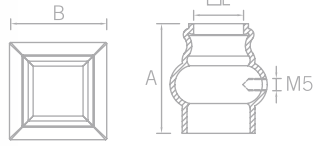

MC 900 BA AISI-316

pcs/box	□L	A	B
4	20x20	45	40



BA SATIN

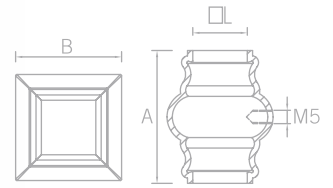

MC 910 BA AISI-316

pcs/box	□L	A	B
4	20x20	50	40



BA SATIN

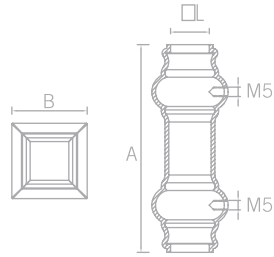

MC 911 BA AISI-316

pcs/box	□L	A	B
2	20x20	110	40



BA SATIN

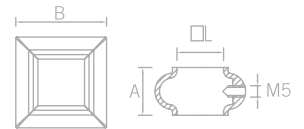

MC 912 BA AISI-316

pcs/box	□L	A	B
4	20x20	21	40



BA SATIN

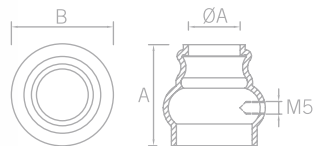

MC 950 BA AISI-316

pcs/box	ØA	A	B
4	20	40	40



BA SATIN

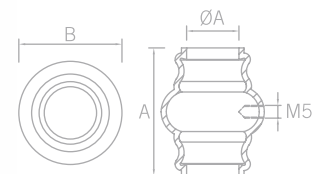

MC 960 BA AISI-316

pcs/box	ØA	A	B
4	20	50	40



BA SATIN

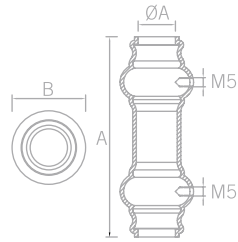

MC 961 BA AISI-316

pcs/box	ØA	A	B
2	20	110	40



BA SATIN

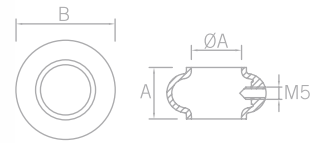

MC 962 BA AISI-316

pcs/box	ØA	A	B
4	20	21	40,5



BA SATIN

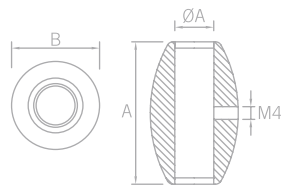

MC 963 BA AISI-316

pcs/box	ØA	A	B
4	12	45	28



BA SATIN



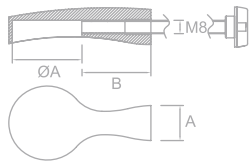

PD 1000 A BA AISI-316

pcs/box	ØA	A	B
1 KIT*	40	21	40
1 KIT*	38,1	21	40



1 KIT*: 2 pcs

BA SATIN

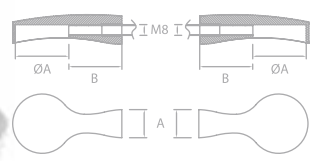

PD 1000 A-B BA AISI-316

pcs/box	ØA	A	B
1 KIT*	40	21	40
1 KIT*	38,1	21	40



1 KIT*: 2 pcs

BA SATIN

Instalación / Installation / Installation

El novedoso sistema de fijación anti-vibración, consigue a través de gomas ubicadas en el interior, un doble efecto:

- Absorber las vibraciones producidas por el uso.
- Mejorar la estética gracias a la eliminación de los tornillos de apriete

[ENG]

The innovative anti-vibration locking system achieves a twofold effect through the rubbers located inside:

- Absorbs vibrations caused by the use
- Improves aesthetics by removing the tightening screws

[FRA]

Grâce au gommages intérieures, le nouveau système de fixation antivibration a un double effet:

- Il absorbe les vibrations produites à cause de l'usage
- Il améliore l'esthétique en supprimant les vis de serrage



[img.1]



[img.2]



[img.3]



[img.4]

BA

Acabado brillo / Polished finished / Finition poli

SATIN

Acabado satinado / Satin finished / Finition brossé



Consultar JF BRICO / View JF Brico / Consulter JF BRICO

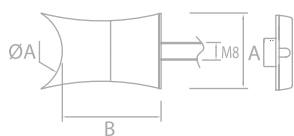

PD 1001 A BA AISI-316

pcs/box	ØA	A	B
1 KIT*	40	44	34



1 KIT*: 2 pcs

BA SATIN

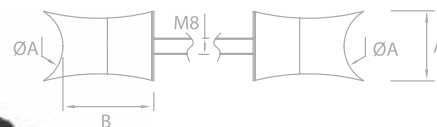
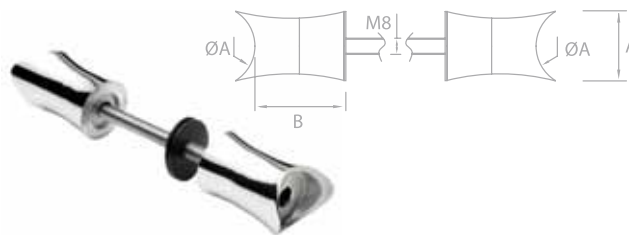

PD 1001 A-B BA AISI-316

pcs/box	ØA	A	B
1 KIT*	40	44	34



1 KIT*: 2 pcs

BA SATIN

Instalación / Installation / Installation



[img.1]



[img.2]



[img.3]



[img.4]

1. Perfiles de acero inoxidable y aluminio [img.1]

2. Superficies de madera [img.2]

3. Superficies de vidrio:

a) Tirador Simple [img.3]

b) Tirador Doble [img.4]

[ENG]

1. Profiles of stainless steel and aluminum [img.1]

2. Wooden surfaces [img.2]

3. Glass surfaces:

a) Simple handle [img.3]

b) Double handle [img.4]

[FRA]

1. Profilés en acier inoxydable et aluminium [img.1]

2. Surfaces en bois [img.2]

3. Surfaces en verre:

a) Poignée Simple [img.3]

b) Poignée Double [img.4]



Barandilla línea R-Concept que distribuye los elementos de una forma uniforme y equilibrada.

The R-Concept-line railing distributes all elements in a uniform and balanced way.

La ligne Balustrade R-Concept distribue des éléments uniformément et de façon équilibrée.



AV-600



AV-601



ST-333



AV-602



ST-308



AV-603



SL-1100



SL-1101



SL-1120



ST-309



ST-310



ST-320



ST-322



ST-324



SA-404



SA-420 BG



SA-450



ST-320



SA-400



SA-405



ST-325



SA-406



SA-413



SA-433



TF-502



TF-511



TF-530



TF-505



TF-501

